



## Glendor Gardens

**£3,400 Per Month**

Cosway Estates are pleased to offer for rent this charming large four-bedroom semi-detached house which is ideally located within walking distance of Mill Hill Broadway, offering easy access to shops, restaurants, cafes, and to Mill Hill Thameslink train station. The ground floor boasts an extended reception room, providing ample space for living, dining, and entertaining, alongside a well-appointed spacious kitchen / diner and a convenient downstairs W/C. On the first floor, you'll find four bedrooms and a family bathroom. Other benefits include a garage, off-street parking for up to three cars and a large rear garden. This property is also conveniently located close to excellent local schools, making it perfect for families. AVAILABLE JULY 2025. Viewings highly advised

### Viewing

Please contact our Mill Hill Office on 02089590011 if you wish to arrange a viewing appointment for this property or require further information.



4



1



2



E



Floor Plan

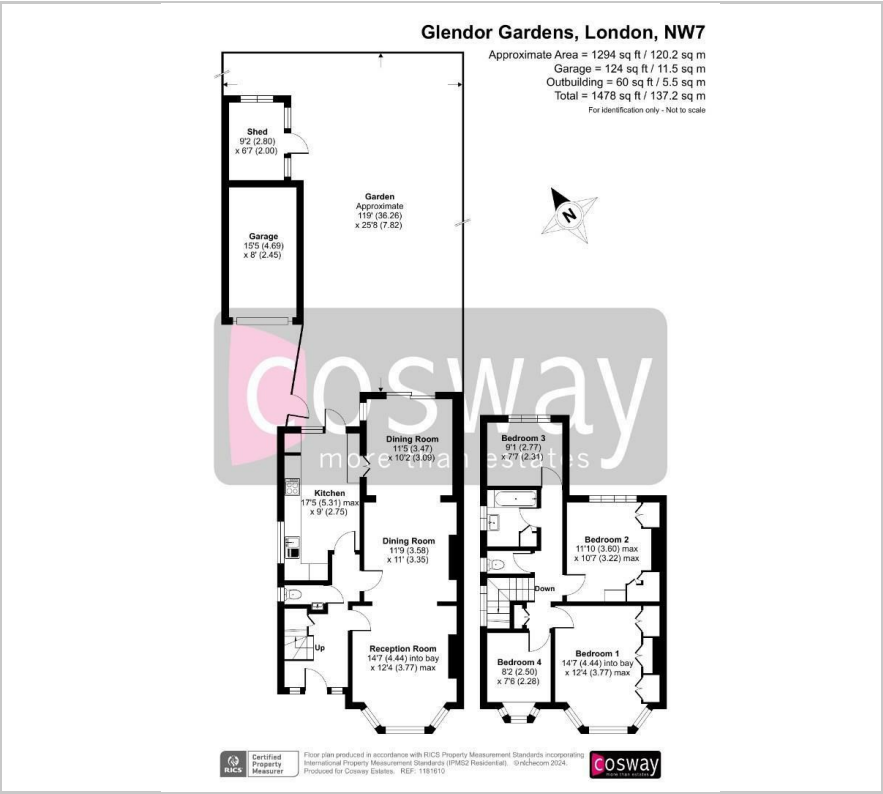

Area Map



Energy Efficiency Graph

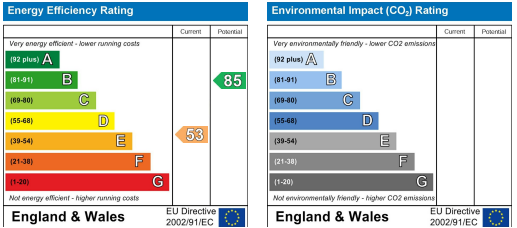

These particulars, whilst believed to be accurate are set out as a general outline only for guidance and do not constitute any part of an offer or contract. Intending purchasers should not rely on them as statements of representation of fact, but must satisfy themselves by inspection or otherwise as to their accuracy. No person in this firms employment has the authority to make or give any representation or warranty in respect of the property.